

#### Description:

The KARAJET FT14 is a Cast Iron low pressure mechanical steam trap with thermostatic air vent. The FT14 can be maintained without disturbing the pipework.

#### Features:

- 1- Continuous discharge of condensate at steam temp.
- 2- Thermostatic air vent for better air venting.
- 3- Simple and reliable construction

#### Size and Pipe Connections:

DN15 to DN25

Screwed BSPT/NPT/BSP and Socket Weld ends.

Available with Class 150 Flange.

Other sizes are available for flanged connection by request.

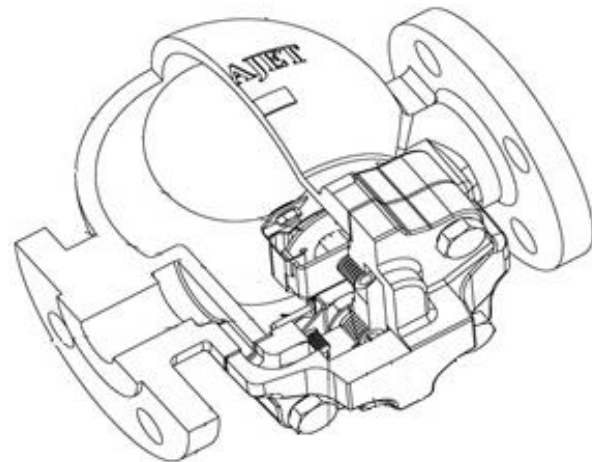

#### Capacity Curve:

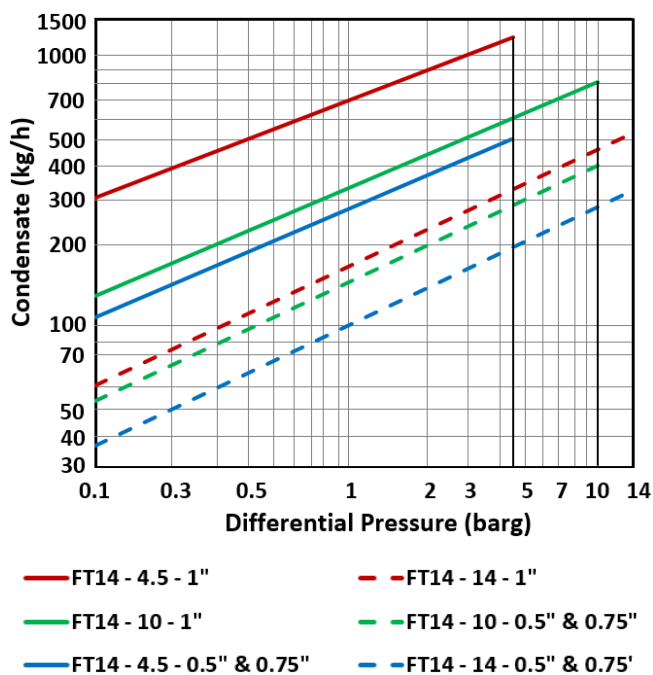

#### Limiting Conditions:

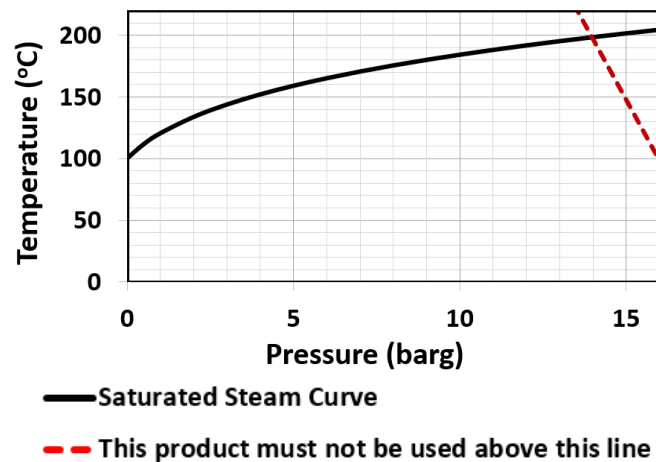

Flange Class	#150
Body Design Conditions	PN16
PMA (Max. Allowable Pressure)	16 barg @ 100 °C
TMA (Max. Allowable Temperature)	250 °C @ 13 barg
PMO (Max. Operating Pressure)	14 barg @ 197.2 °C
TMO (Max. Operating Temperature)	250 °C @ 13 barg
Max. Cold Hydro Test Pressure	24 barg

#### Material:

No.	Part	Material
1	Body	Cast Iron
2	Cover	Cast Iron
3	Valve Assembly	A240 Gr.304
4	Air Vent Assembly	Bimetal - A479 Gr.304
5	Seat	A479 Gr.304
6	Cover gasket	Reinforced Graphite
7	Cover Bolts	Carbon Steel

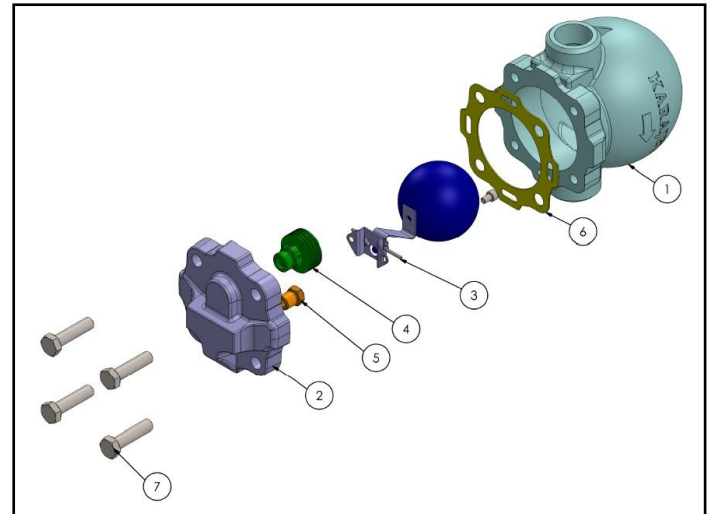

#### Spare Part List:

No.	Part No.	Part
1	3	Valve Assembly
2	4	Air Vent Assembly
3	6	Gaskets

#### Dimensions (mm):

Size	A	B	C	D	Weight (kg)	
					Screwed	#150
1/2"	167	110	68	165	4.1	4.9
3/4"	170	110	68	165	4	5.3
1"	173	110	68	165	4	5.7

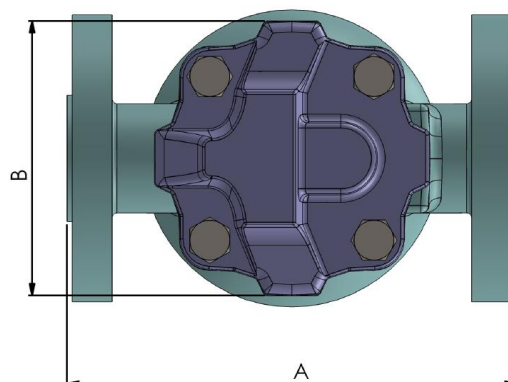
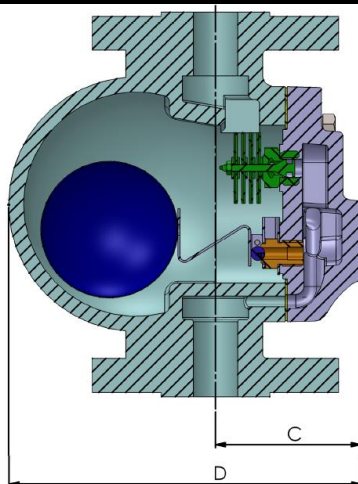

#### Description:

The KARAJET FT44 is a Carbon steel medium pressure mechanical steam trap with an integral strainer and thermostatic air vent. Their main features is compactness with high condensate capacity.

#### Size and Pipe Connections:

DN40 and DN50  
Screwed BSPT/NPT/BSP and Socket Weld ends.  
Available with Class 150, 300 Flanges.  
Other sizes are available for flanged connection by request.

#### Material:

Other body materials such as Cast Iron (PN 16) and Stainless Steel A351-CF8 are available.

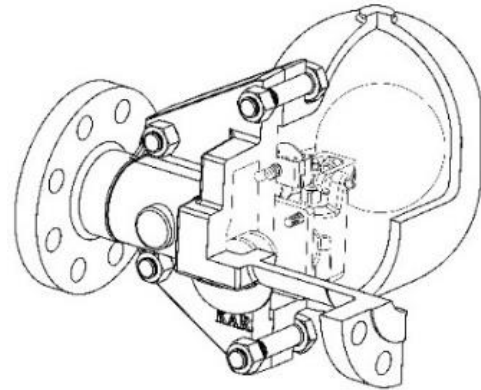

#### Capacity Curve:

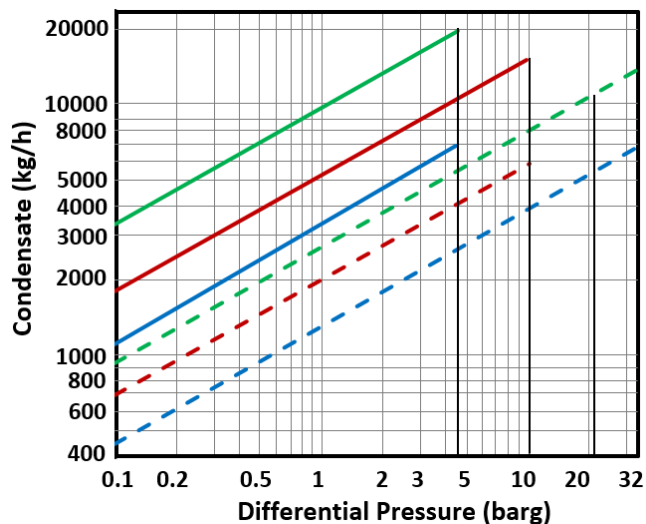

- FT44 - 4.5 - 2"
- FT44 - 10 - 2"
- FT44 - 4.5 - 1.5"
- - - FT44 - 21 - 2" and FT44 - 32 - 2"
- - - FT44 - 10 - 1.5"
- - - FT44 - 21 - 1.5" and FT44 - 32 - 1.5"

#### Limiting Conditions:

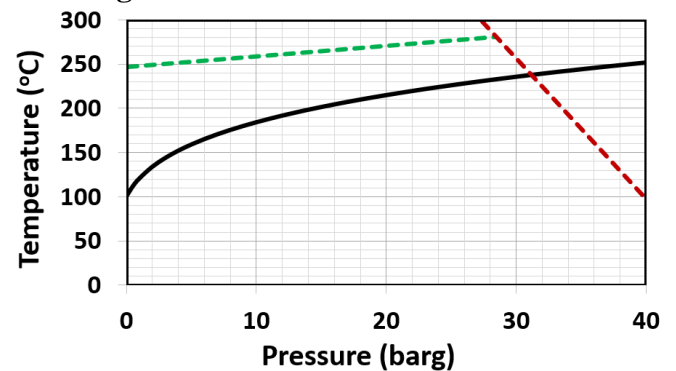

— Saturated Steam Curve

- - - This product should not be used above this line

- - - This product must not be used above this line

For #150 the Pressure/Temperature ratings is limited by flange class.

Flange Class	#150	#300
Body Design Conditions	PN40	PN40
PMA (Max. Allowable Pressure)	19.3 barg @ 37.8°C	40 barg @ 100 °C
TMA (Max. Allowable Temperature)	300 °C @ 10barg	300 °C @ 27.5 barg
PMO (Max. Operating Pressure)	13.8 barg @ 197.2°C	32 barg @ 239 °C
TMO (Max. Operating Temperature)	263.7 °C @ 11.3barg	285 °C @ 28.5barg
Max. Cold Hydro Test Pressure	27 barg	60 barg

#### Material:

No.	Part	Material
1	Body	CS A216 WCB
2	Cover	CS A216 WCB
3	Valve Assembly	SS 304
4	Air Vent Assembly	Bimetal - A479 Gr.304
5	Strainer Screen	A240 Gr.304
6	Damper	A240 Gr.304
7	Cover Bolts	Carbon Steel
8	Cover Gasket	Reinforced Graphite
9	Cover Nuts	Carbon Steel

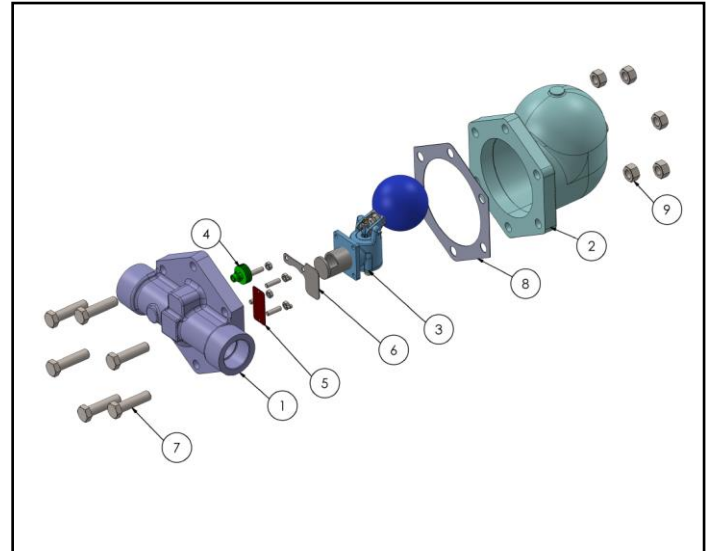

#### Spare Part List:

No.	Part No.	Part
1	3	Main Valve Assembly
2	4	Air Vent Assembly
3	8	Gaskets

#### Dimensions (mm):

Size	A		B	C	D	E	F	Weight (kg)		
	#150	#300						SW	#150	#300
1 1/2"	314	320	300	125	251	138	147	17.5	28.5	30.6
2"	314	320	300	125	251	138	147	22	29.2	30.7

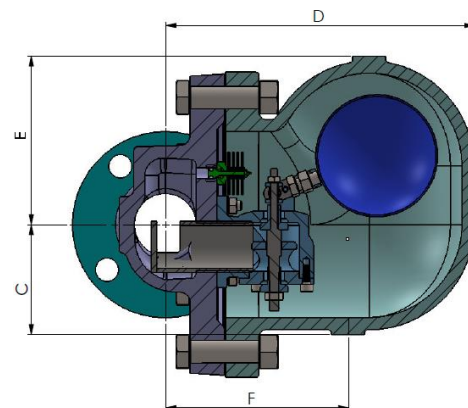
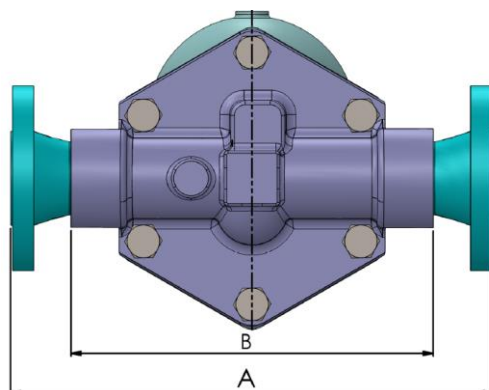

#### Description:

The KARAJET FT44-HC is a carbon steel medium pressure mechanical steam trap with an integral strainer and thermostatic air vent. Their main features are simple construction and reliable operation.

#### Size and Pipe Connections:

DN15 to DN25

Screwed BSPT/NPT/BSP and Socket Weld ends.

Available with Class 150, 300 Flanges.

Other sizes are available for flanged connection by request.

#### Material:

Other body materials such as Cast Iron (PN 25) and Stainless Steel A351-CF8 are available.

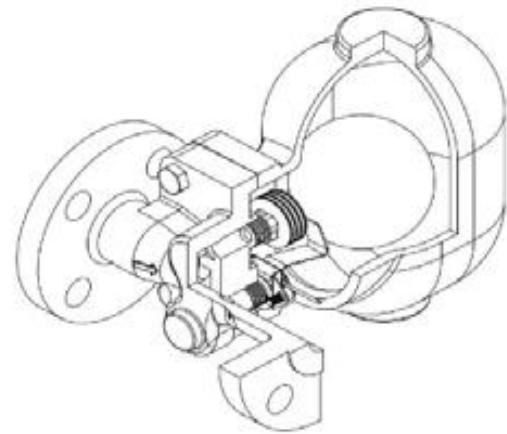

#### Capacity Curve:

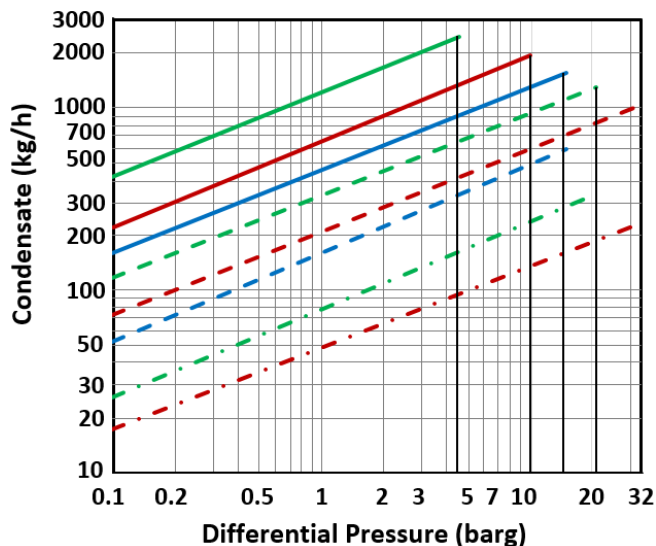

- FT44-HC - 4.5 - 1"
- FT44-HC - 10 - 1"
- FT44-HC - 14 - 1"
- - FT44-HC - 21 - 1" and FT44-HC - 4.5 - 0.5" & 0.75"
- - FT44-HC - 32 - 1" and FT44-HC - 10 - 0.5" & 0.75"
- - FT44-HC - 14 - 0.5" & 0.75"
- - FT44-HC - 21 - 0.5" & 0.75"
- - FT44-HC - 32 - 0.5" & 0.75"

#### Limiting Conditions:

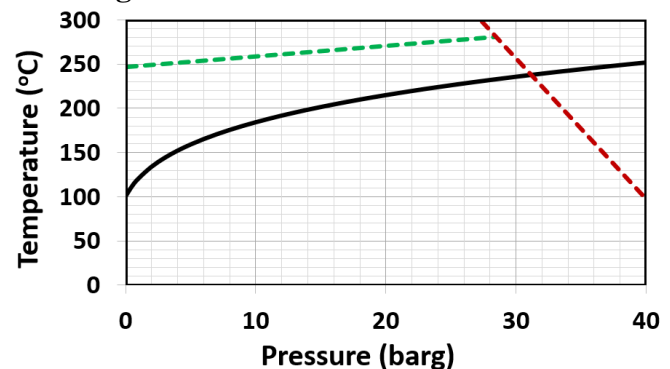

— Saturated Steam Curve

- - This product should not be used above this line

- - This product must not be used above this line

For #150 the Pressure/Temperature ratings is limited by flange class.

Flange Class	#150	#300
Body Design Conditions	PN40	PN40
PMA (Max. Allowable Pressure)	19.3 barg @ 37.8°C	40 barg @ 100 °C
TMA (Max. Allowable Temperature)	300 °C @ 10barg	300 °C @ 27.5 barg
PMO (Max. Operating Pressure)	13.8 barg @ 197.2°C	32 barg @ 239 °C
TMO (Max. Operating Temperature)	263.7 °C @ 11.3barg	285 °C @ 28.5barg
Max. Cold Hydro Test Pressure	27 barg	60 barg

### Material:

No.	Part	Material
1	Body	CS A216 WCB
2	Cover	CS A216 WCB
3	Ball Float	A240 Gr.304
4	Air Vent Assembly	Bimetal - A479 Gr.304
5	Valve Seat	A479 Gr.304
6	Lever and Pivot Frame	A240 Gr.304
7	Strainer Screen and Bolts	A240 Gr.304
8	Valve Seat Gasket	A240 Gr.304
9	Cover Gasket	Reinforced Graphite
10	Cover Bolts	Carbon Steel

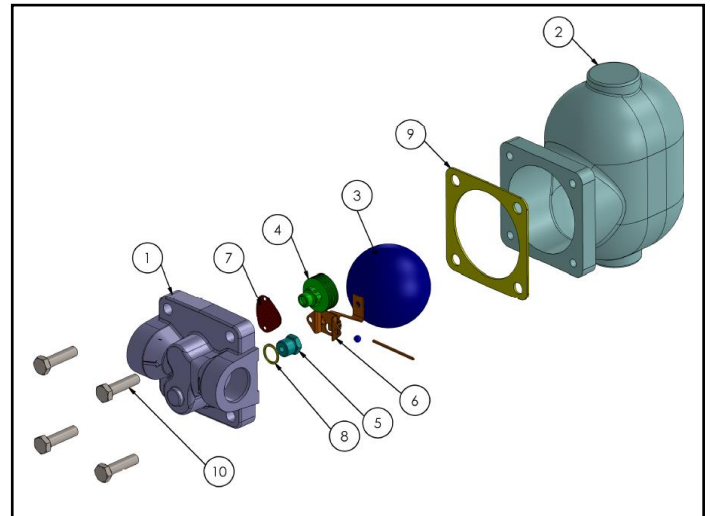

### Spare Part List:

No.	Part No.	Part
1	6, 5	Main Valve Assembly
2	3	Ball Float
3	4	Air Vent Assembly
4	8, 9	Gaskets

### Dimensions (mm):

Size	A		B	C	D	E	F	Weight (kg)		
	#150	#300						SW	#150	#300
0.5"	203	209	120	111	84	195	125	6.8	8.3	8.7
0.75"	206	213	120	111	84	195	125	6.8	8.6	9.3
1"	209	216	120	111	84	195	125	6.8	9	10.1

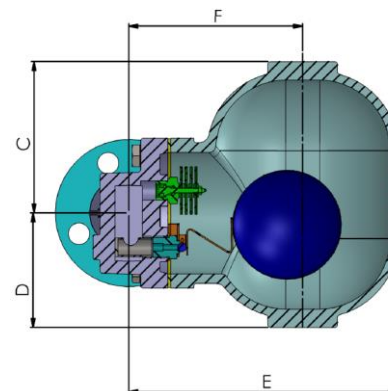
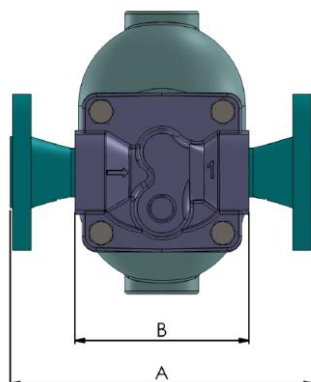



#### Description:

The KARAJET FT44-D is a carbon steel medium pressure mechanical steam trap with an integral strainer and thermostatic air vent for very high capacity applications.

#### Size and Pipe Connections:

DN40 and DN50

Available with Class 150 Flange ends.

Other sizes are available for flanged connection by request.

#### Material:

Other body materials such as Cast Iron (PN 16) and Stainless Steel A351-CF8 are available.

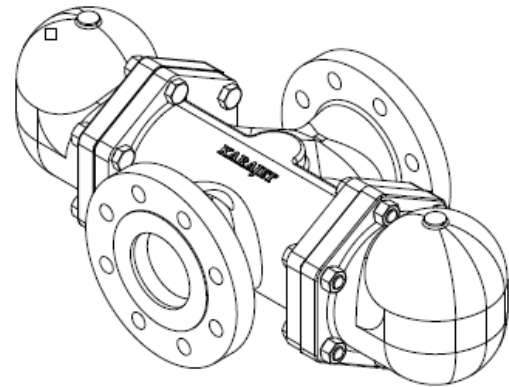

#### Capacity Curve:

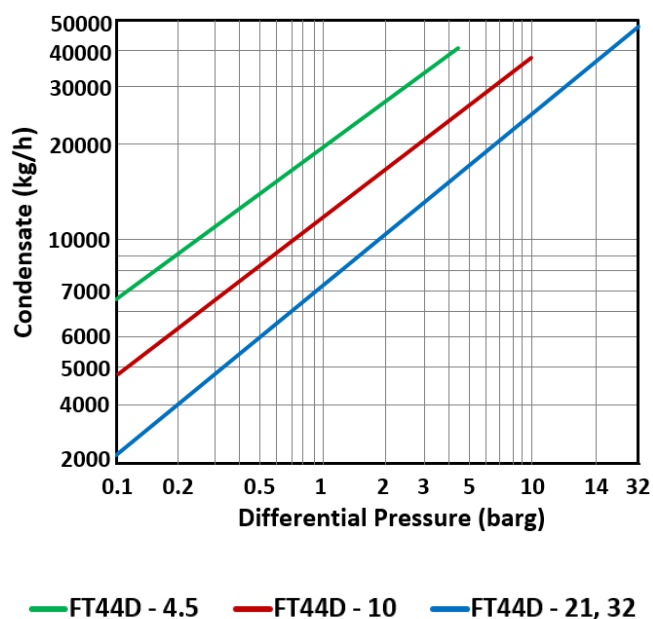

#### Limiting Conditions:

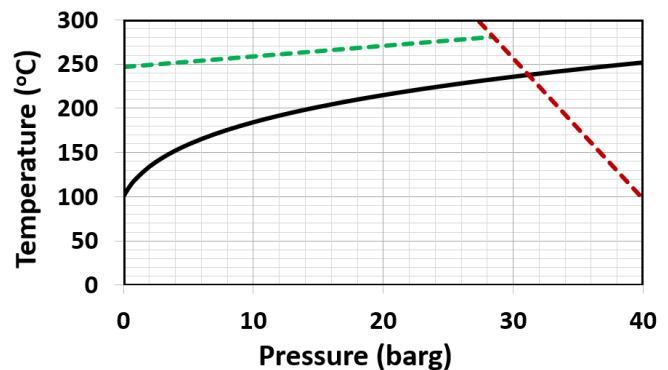

— Saturated Steam Curve

--- This product should not be used above this line

--- This product must not be used above this line

For #150 the Pressure/Temperature ratings is limited by flange class.

Flange Class	#150	#300
Body Design Conditions	PN40	PN40
PMA (Max. Allowable Pressure)	19.3 barg @ 37.8°C	40 barg @ 100 °C
TMA (Max. Allowable Temperature)	300 °C @ 10barg	300 °C @ 27.5 barg
PMO (Max. Operating Pressure)	13.8 barg @ 197.2°C	32 barg @ 239 °C
TMO (Max. Operating Temperature)	263.7 °C @ 11.3barg	285 °C @ 28.5barg
Max. Cold Hydro Test Pressure	27 barg	60 barg

#### Material:

No.	Part	Material
1	Body	CS A105
2	Cover	CS A216 WCB
3	Valve Assembly	SS 304
4	Air Vent Assembly	Bimetal - A479 Gr.304
5	Strainer Screen	A240 Gr.304
6	Damper	A240 Gr.304
7	Cover Gasket	Reinforced Graphite
8	Cover Studs	Carbon Steel
9	Cover Nuts	Carbon Steel

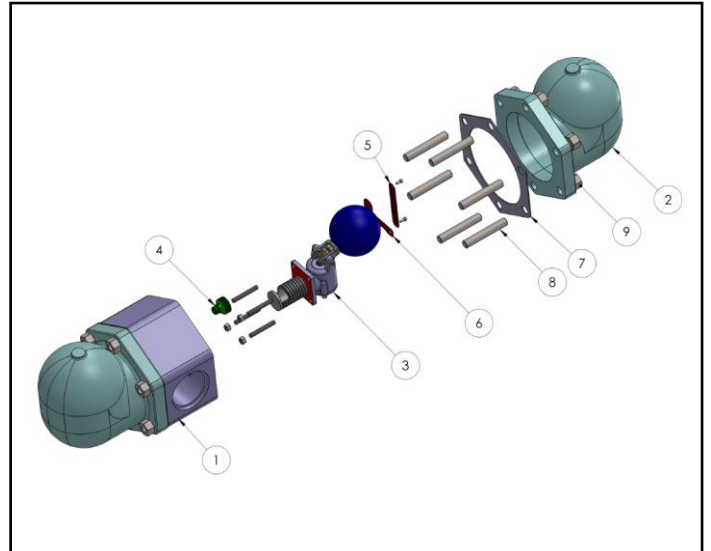

#### Spare Part List:

No.	Part No.	Part
1	3	Main Valve Assembly
2	4	Air Vent Assembly
3	7	Gaskets

#### Dimensions (mm):

Size	#150	B	C	D	E	F	Weight (kg)
3"	343	266	266	124	138	532	72
4"	350	266	266	124	138	532	74

