

#### Description:

The KARAJET T3 is an inline carbon steel low pressure bimetallic thermostatic steam trap with an integral strainer. Typical applications include steam tracing lines etc.

#### Size and Pipe Connections:

DN8 to DN25  
Screwed BSPT/NPT/BSP and Socket Weld ends.  
Available with Class 150 and 300 Flanges.  
Other sizes are available for flanged connection by request.

#### Material and Options:

Other body materials such as Stainless Steel A182 F304–F316 are available.

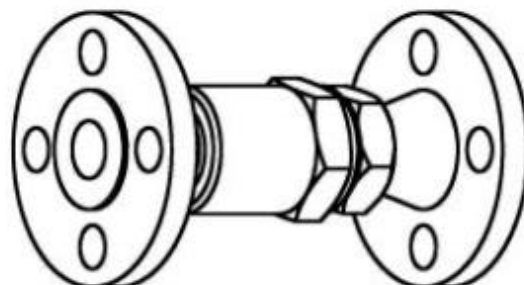

#### Capacity Curve:

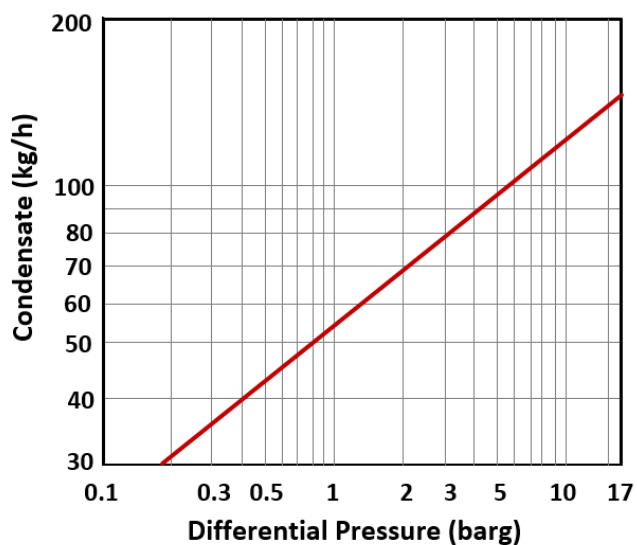

Recommended Safety Factor: 1.5

#### Limiting Conditions:

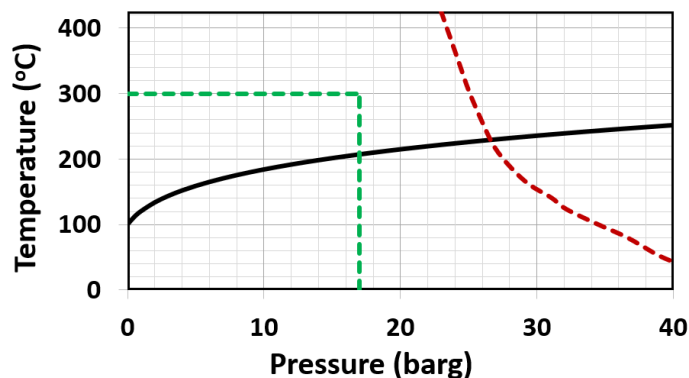

- Saturated Steam Curve
- - - This product should not be used outside of this line
- - - This product must not be used above this line

Body Design Conditions	PN 50
PMA (Max. Allowable Pressure)	40 barg @ 50 °C
TMA (Max. Allowable Temperature)	425 °C @ 23 barg
PMO (Max. Operating Pressure)	17 barg @ 300 °C
TMO (Max. Operating Temperature)	300°C @ 17 barg
Max. Cold Hydro Test Pressure	62 barg

#### Material:

No.	Part	Material
1	Body	CS A105
2	Cap	CS A105
3	Valve Assembly	Bimetal
4	Strainer Screen	SS304 / SS316
5	Body Gasket	SS304 / SS316
6	Valve Gasket	SS304 / SS316
7	Circlip	SS304 / SS316

#### Spare Part List:

No.	Part No.	Part
1	3	Valve Assembly
2	4	Strainer Screen
3	5, 6	Gaskets

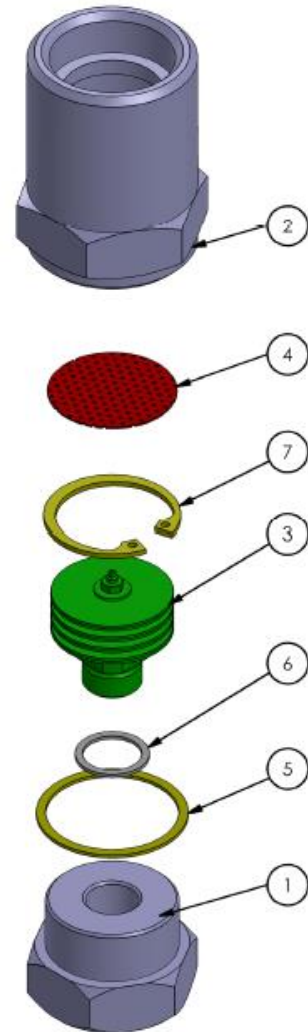

#### Dimensions (mm):

Size	A	B	C	D	Approx. Weight (kg)
½"	156	80	46	46	0.7
¾"	160	80	46	46	0.7
1"	166	80	46	46	0.7

