

Steam Trap

Description:

The KARAJET TD120 is an alloy steel steam trap for very high pressure applications with an integral strainer and a replaceable seat for ease of maintenance. Their specific application is for superheated mains drainage up to 250 bar g.

Size and Pipe Connections:

DN15 to DN25
Screwed BSPT/NPT/BSP and Socket Weld ends.
Available with Class 900, 1500 Flanges.
Other sizes are available for flanged connection by request.

Material and Options:

Other body materials such as Stainless Steel 420 are available.

Capacity Curve:

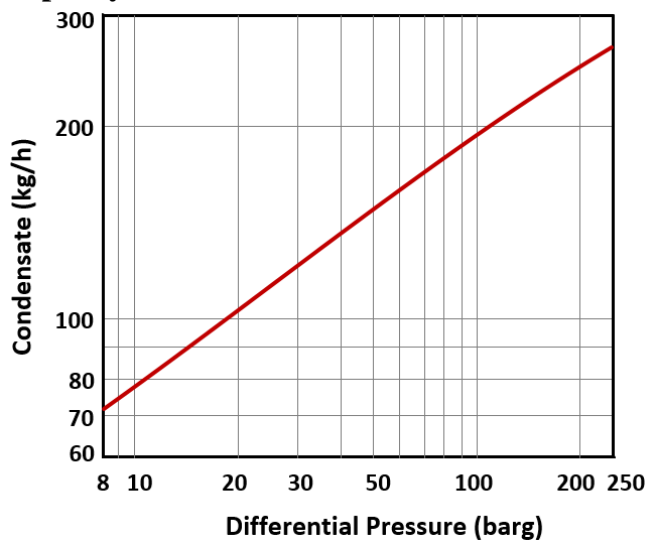

Recommended Safety Factor: 1.5

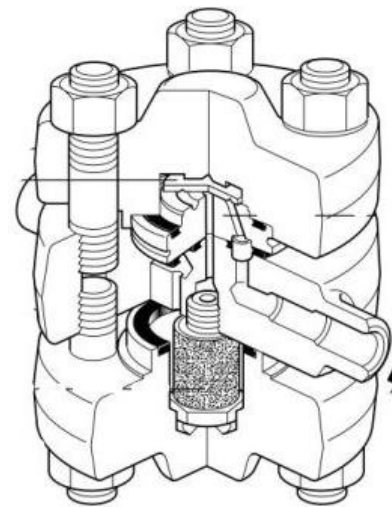

Limiting Conditions:

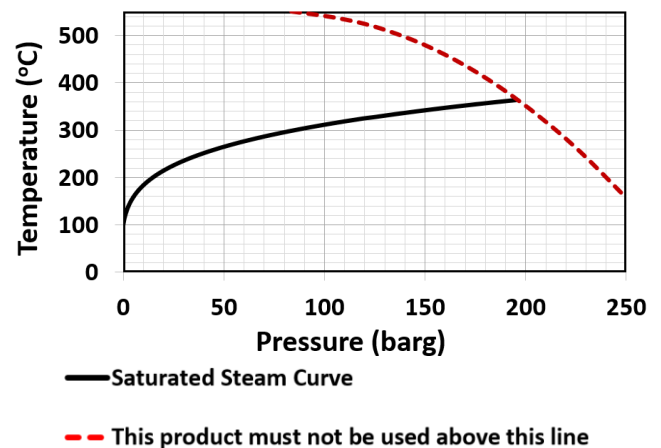

Body Design Conditions	PN 250
PMA (Max. Allowable Pressure)	250 barg @ 300 °C
TMA (Max. Allowable Temp.)	550 °C @ 80 barg
PMO (Max. Operating Pressure)	220 barg @ 374 °C
TMO (Max. Operating Temp.)	550 °C @ 80 barg
Max. Cold Hydro Test Pressure	375 barg

PMOB-Max. Operating Back Pressure on outlet should not exceed 50% of inlet pressure.

Minimum operating differential pressure is 8 bar g.

Steam Trap

Material:

No.	Part	Material
1	Body	A182 F11 / F12
2	Top Cover	A182 F11 / F12
3	Bottom Cover	A182 F11 / F12
4	Seat	SS 420
5	Disk	SS 420
6	Strainer Assembly	SS304 / SS316
7	Seat Gasket	SS304 / SS316
8	Cover gasket	Spiral Wound
9	Cover Studs	Stainless Steel
10	Cover Bolts	Stainless Steel

Spare Part List:

No.	Part No.	Part
1	5	Disc & Seat
2	6	Strainer Assembly
3	7, 8	Gaskets

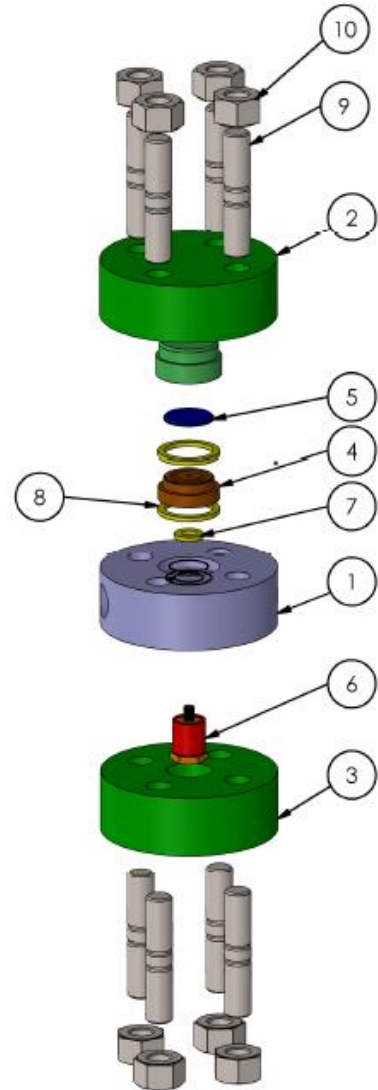

Dimensions (mm):

Size	A		B	C	D	Approx. Weight (kg)	
	#900	#1500				#900	#1500
½"	235	235	104	104	135	25	26
¾"	245	245	104	104	135	26	27
1"	250	250	104	104	135	27	28

